

**External venetian blinds from Griesser.  
Lamisol® III System**

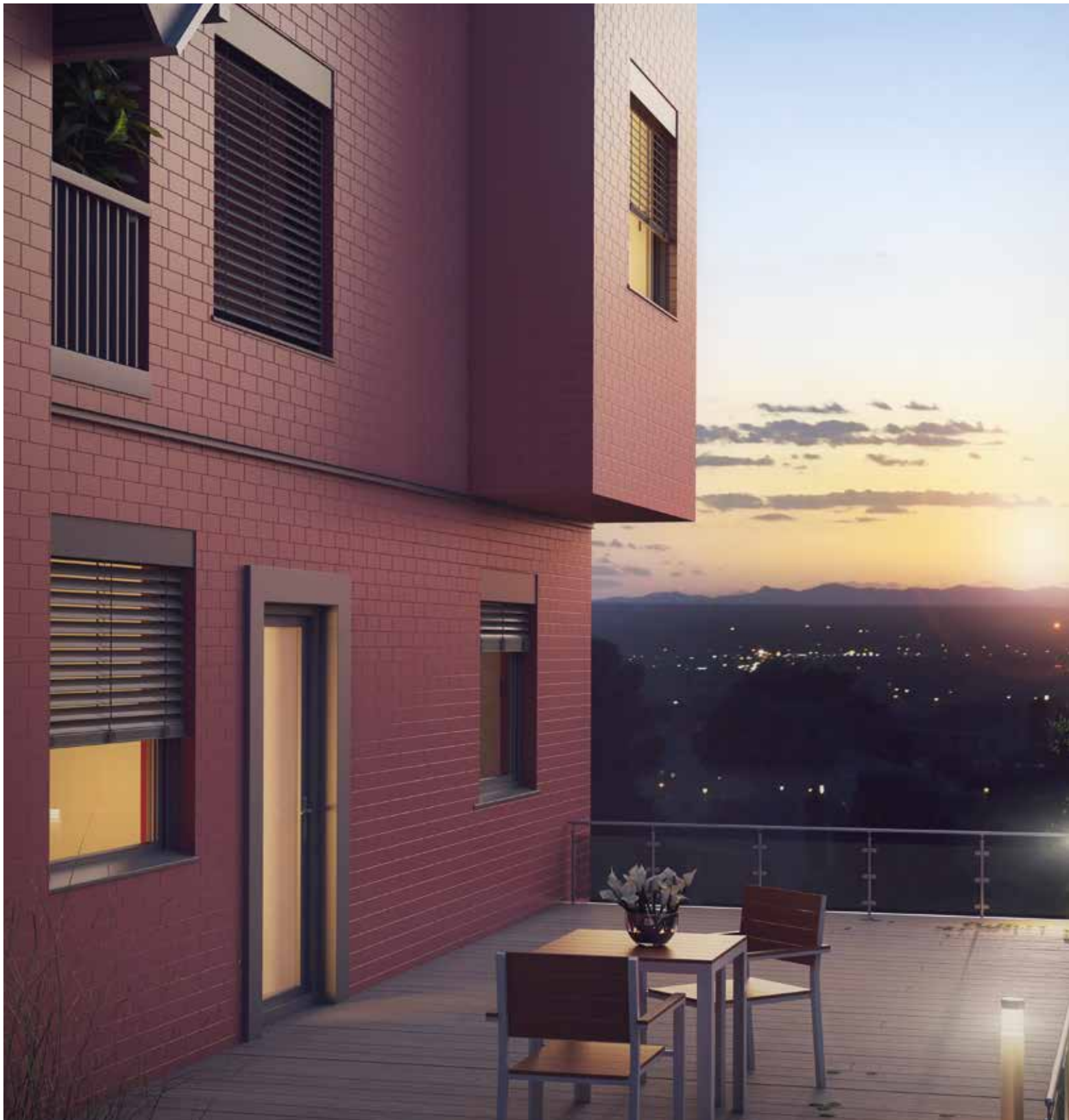







## Lamisol® III System

Lamisol® III System is a self-supporting, motorized system designed for positioning on window frames with two options for installation. The system comes as a box version for front installation or as a profile version for building into the niche. Guides and box are flush to the rear and sides. Lamisol® III System can be easily planned and measured and, because the curtain is pre-installed, is exceptionally easy to install. Lamisol® III System can be ordered with Lamisol® III 90 curtain or with Lamisol® III 70 curtain for narrow spaces. The operating position makes it possible to prevent the dark phase when the blind is lowered.





Self-supporting



Measure competently –  
order and install easily



Lamisol® III System  
Box



Lamisol® III System  
Profil



Two different slat  
widths

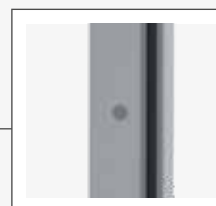

Screw fastened cover  
(black/white/gray)

## Product-Highlights Lamisol® III System



Adjusting cords



Operating position  
(option)

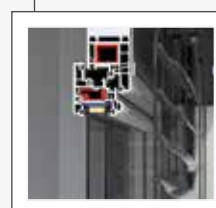

Guides attached to  
window frames

---

## PRODUCT ADVANTAGES IN DETAIL

---



### Self-supporting blind system

Lamisol® III System is a self-supporting system and is positioned on the window frame. Mounting holes are available on the side or at the rear for fastening the guides which reduces thermal bridges around the lintel area.



### Measure competently – order and install easily

Measurements must be taken such that the product fits completely into the application in width, height and depth because of the compact blind design. This will make it easy to order and quick to install.



### Two slat widths

Lamisol® III 90 meets today's installation conditions in renovations and remodels. Lamisol® III 70 is geared to the tight installation conditions found in renovation and remodeling situations.



### Operating position (option)

When a blind is first lowered, there is often a moment of disruption – especially on a work space. The operating position of approximately 48 degrees prevents this dark phase when the blind is lowered.



### Adjusting cords with Kevlar

Yellow Kevlar fibers ensure that there is barely any expansion and shrinkage – the blind closure stays perfect for many years.



### Lamisol® III System Box

The box inserts smoothly into the facade. No additional fasteners are needed up to a width of 4 m.



### Lamisol® III System Profil

Lamisol® III System profil is used for concealed installation in a niche. No additional fasteners are needed up to a width of 4.5 m.



## Our color scheme

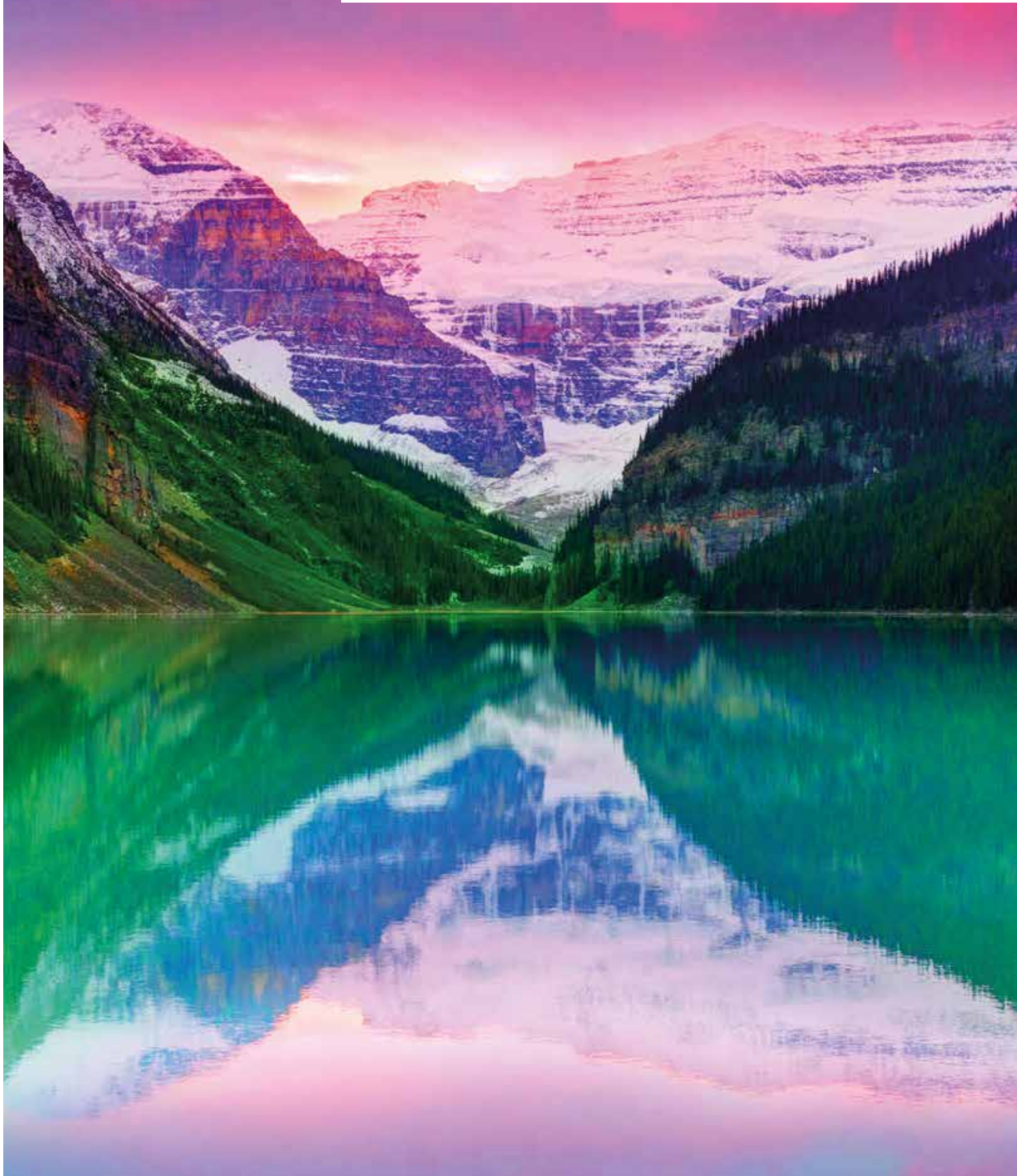

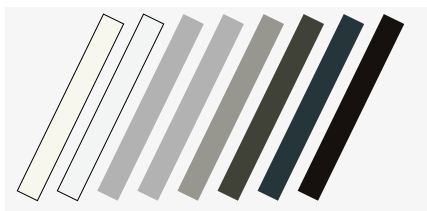

#### Surface structure

Semi-gloss











#### Surface structure

Semi-gloss



## OUR COLORS

### STANDARD COLORS

			
RAL 9010	RAL 9016	RAL 9006	VSR 140
			
RAL 9007/VSR 907	RAL 7022	RAL 7016	RAL 8019

### PREMIUM COLORS

#### GriRal Colors

Our GriRal color collection has an assortment of 50 different RAL shades of color. From sand yellow to standard white, we offer a complete selection of hues for every color family. We're convinced that with our color palette, you will find exactly the right shade of color for your needs.

#### GriColors

The GriColors range includes 100 color shades in four collections, Glass & Stone, Sun & Fire, Water & Moss and Earth & Wood – from cool white and sunny red to natural blue and earthy brown.

#### BiColor

External venetian blinds get a new color accent: When bright color is dominant outside, a neutral light can optimize the shading function inside. Create your own preferred color combination using our two color collections, GriColors and GriRal (excluding standard colors).

The exterior color shows as a border along the edge of the interior view. Our color recommendations for interior colors: white (VSR 901), light gray (VSR 904) or medium gray (VSR 130).

### SPECIAL COLORS

Color means individuality - there are practically no limits to our Special Colors. No wish goes unanswered with additional innumerable and facade-ready color tones.



## Our comfort





---

## CONTROLS

---

Lamisol® III System can be operated through a variety of control systems, from a simple hand-held transmitter to a master control or a building management system, depending on the time, position of the sun and the weather.

---

### Thermal comfort

The ambient conditions change over the course of the day and during the seasons. With a blinds control device from Griesser, you can adjust your solar shading to match your personal requirements in accordance with changing exterior circumstances. And making these adjustments is so simple that you will still have time to take care of the important things in your life.

An optimal daylight concept makes artificial air conditioning superfluous in the summer. You save energy costs and may well also avoid one or another unwanted summer cold. In the winter, on the other hand, a solar shading system can protect you against cold and allow the scarce rays of the sun into the room, thus saving once again on energy costs, not to mention facial tissues.

---

### Visual comfort

Having a sense of well-being also means being able to decide for oneself, particularly within one's own four walls, just how much one wants to reveal to the outside world. With Lamisol® III System, you are sheltered from uninvited glances from the outside world.

---

### BILINE - REMOTE CONTROL

The control system Griesser BiLine provides contemporary design and high functional security through routing technology. Wireless systems have the advantage of being installed quickly, not only in new buildings but also when refitting an automated system in existing buildings.

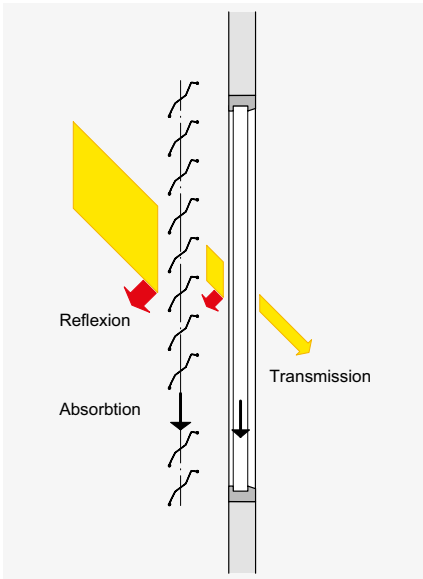

BiLine hand-held transmitter



Centero server for iPad and iPhone operation



---

### KNX / GBUS HOME AND BUILDING AUTOMATION

The Griesser KNX and gBUS solar shading controls are integrated master controls with extensive functionalities for any building of any size. With proven functions such as solar tracking and horizon limitation, it meets the highest expectations for solar shading control.



KNX / gBUS controls per iPad











# Technology in detail

## Vertical section

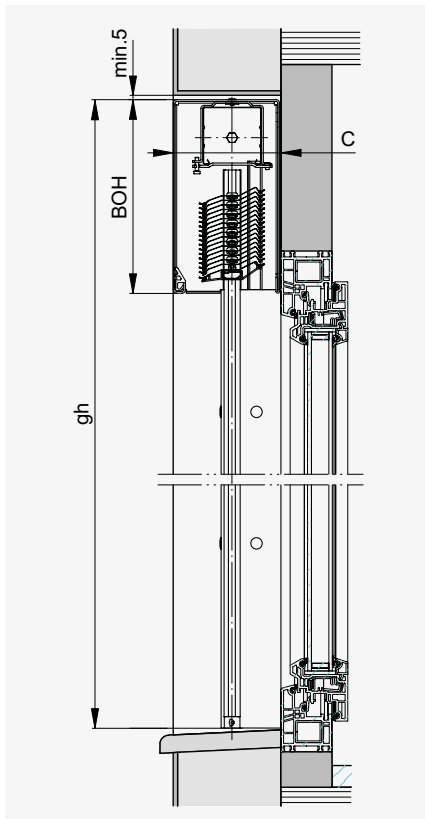

## LAMISOL® III SYSTEM BOX



### System Box

Box Fix made of profiled aluminum, square, in four different box heights for connection with the guide rails and for the holder of the slat package and the fastening of the housing.

## Box height



## Box dimensions

Lamisol® III 70 System Box		Lamisol® III 90 System Box	
Total height gh	Box height BOH	Total height gh	Box height BOH
590–1440	190	620–2120	220
1441–1920	220	2121–2860	260
1921–2510	260	2861–3650	300
2511–3200	300	3651–4660	300 <sup>1)</sup>
3201–4700	300 <sup>1)</sup>		
Depth of box C	121	Depth of box C	141

<sup>1)</sup> Slat package not fully covered

## Lateral guide rails

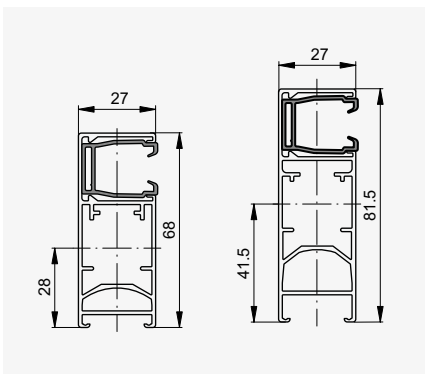

## Guide rails

Fix guide rails made of extruded aluminum in two different depths for guiding the curtain and fastening the blinds to the side or to the rear. Embedded beading reduces transmission of the sounds of wind. The guide end prevents the curtain from falling in the event of damage.

	Lamisol® III 70 System Box	Lamisol® III 90 System Box
Deep guide rails	68	81.5



## Vertical section

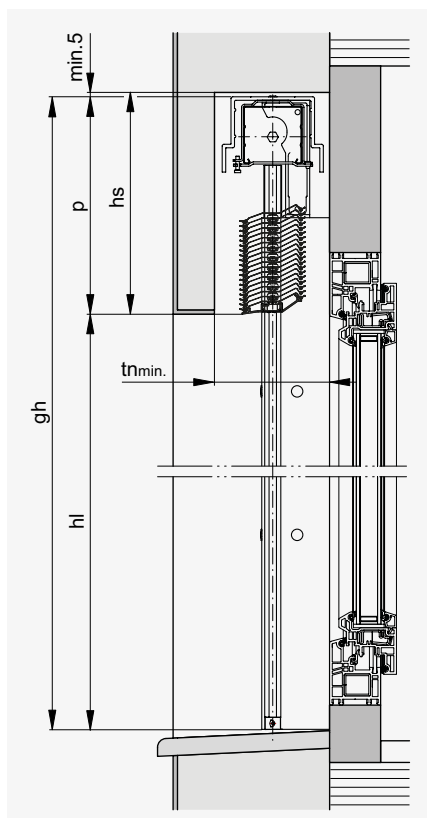

## LAMISOL® III SYSTEM PROFIL



### System Profil for niche installation

Fix profil made of profil aluminum for fastening the housing.

### Header dimensions

## Support profil



	Lamisol® III 70 System Profil	Lamisol® III 90 System Profil
<b>Depth of niche (tn)</b>	130	130
<b>Opening height (hl)</b>	<b>Header height (hs)</b>	
400–1750	235	225
1751–2000	250	235
2001–2250	265	250
2251–2500	285	260
2501–2750	300	275
2751–3000	315	290
3001–3250	335	305
3251–3500	350	320
3501–3750	365	330
3751–4000	385	350
4001–4300	400	365

Header dimensions are approximate values which may exhibit negative or positive deviations depending on the technical circumstances.

## Lateral guide rails

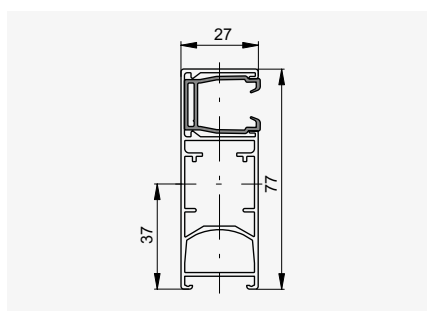

### Guide rails

Fix guide rails, 27 x 77 mm, made of extruded aluminum for guiding the curtain and fastening the blinds to the side or to the rear. Embedded beading reduces transmission of the sounds of wind.

---

## LIMIT DIMENSIONS VERSION BOX

---

### bk Width of construction (rear edge of guide rails)

#### Minimum

Lamisol® III 70 System Box	600
Lamisol® III 90 System Box	500

#### Maximum

Lamisol® III System Box	4000
-------------------------	------

Buildings and high-rise structures which are exposed to high wind should decrease this maximum value as required (see operating instructions).

---

### gh Total height

#### Minimum

Lamisol® III System Box	590
-------------------------	-----

#### Maximum

Lamisol® III System Box	4700
-------------------------	------

---

### bk × hl Maximum surface area

#### Single blind

Lamisol® III System Box	10 m <sup>2</sup>
-------------------------	-------------------

Lamisol® III System motorized only, no coupling possible.

---

## LIMIT DIMENSIONS VERSION PROFIL

---

### bk Width of construction (rear edge of guide rails)

#### Minimum

Lamisol® III 70 System Profil	600
Lamisol® III 90 System Profil	500

#### Maximum

Lamisol® III 70 System Profil	4500
Lamisol® III 90 System Profil	4550

Buildings and high-rise structures which are exposed to high wind should decrease this maximum value as required (see operating instructions).

---

### hl Opening height

#### Minimum

Lamisol® III 70 System Profil	400
Lamisol® III 90 System Profil	380

#### Maximum

Lamisol® III 70 System Profil	4300
Lamisol® III 90 System Profil	5000

---

### bk × hl Maximum surface area

#### Single blind

Lamisol® III System Profil	10 m <sup>2</sup>
----------------------------	-------------------

Lamisol® III System motorized only, no coupling possible.

---

## KEY

bk = Width of construction  
gh = total height  
hl = Opening height  
p = Height of package  
hs = Header height (p + min. 5)  
tn = Depth of niche  
All dimensions in mm.









**Your partner:**

Griesser solar shading - Quality since 1882.  
[www.griessergroup.com](http://www.griessergroup.com)

